

THE PROFESSIONAL DISMOUNTING TOOL

Twin Puller TP 150 – Professional dismounting of deep groove ball bearings and radial shaft seals



simatool TP 150 – The compact tool set for most dismounting situations

The simatool Twin Puller TP 150 can be used to dismount deep groove ball bearings and radial shaft seals in an expert fashion. Bearings with a tight fit on the inner or outer ring can be quickly and reliably dismounted with the help of this tool. The TP 150 can also be used to dismount shaft seals, thus making it a unique and professional dismounting tool.

- Three dismounting functions in one tool set
- Perfect complement to the established simatool Fitting Tool FT 33
- Compact case with high-quality tool parts
- Suitable for shaft diameters from 10 to 100 mm and external diameters up to 150 mm



simatool[®]
smart tools

Suitable for the following bearings:

Bearing name			
60..	62..	63..	64..
6000 6001 6002 6003	6200		
6004 6005 6006	6201 6202 6203		
6007 6008 6009 6010	6204 6205	6300 6301 6302	
6011 6012 6013	6206	6303 6304	
6014 6015 6016 6017	6207 6208 6209 6210 6211	6305 6306 6307	6403
6018 6019 6020	6212 6213 6214 6215 6216 6217	6308 6309 6310 6311 6312 6313	6404 6405 6406 6407 6408 6409 6410

The case contains:

- 6 sets of extraction arms
- 2 threaded spindles
- Grip handle
- 9 support washers
- Sliding hammer
- Extension for sliding hammer
- 50 tapping screws
- 10 spacer rings

Demo videos online:



Professional dismounting with Twin Puller TP 150

Removing radial shaft seals

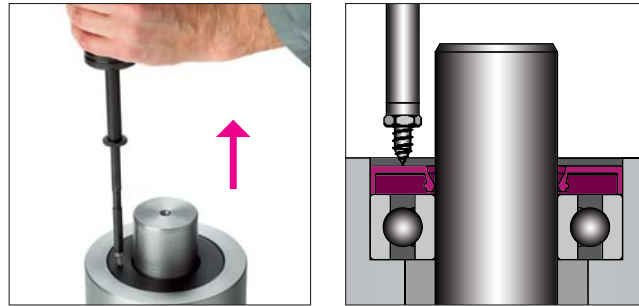

Hammer the tapping screw into the seal and screw it in. Remove the seal by hitting it in the opposite direction with the sliding hammer.

Removing deep groove ball bearings with a press fit on the inner ring (shaft)

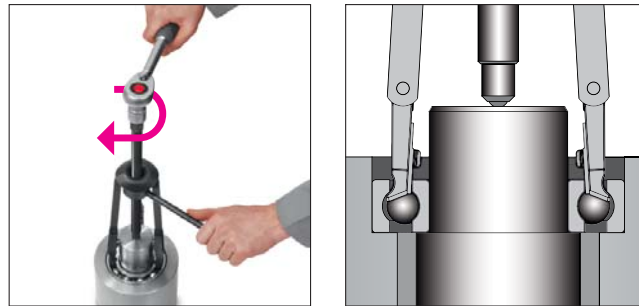

Place the extraction arms between the rolling elements in the bearing. Use the threaded spindle to remove the bearing from the shaft.

Removing deep groove ball bearings with a press fit on the outer ring (housing)

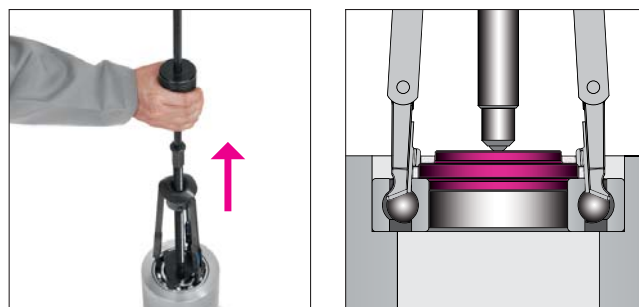

The support washer replaces the shaft on the inner ring and is tensioned using the threaded spindle. Remove the bearing by using the sliding hammer.

simatec ag
 Stadthof 2, CH-3380 Wangen a. Aare
 Tel.: +41 (0)32 636 50 00
 Fax: +41 (0)32 636 50 19
 welcome@simatec.com
 www.simatec.com

610.9341/1210

MAAHANTUOJA:

YTM-Industrial
 INDUSTRAL GROUP

Tiilenlyöjänkuja 9 B, 01720 Vantaa
 Puh. 029 006 230, fax. 029 006 1230
 www.ytm.fi, e-mail ytm.info@ytm.fi

simatec
 smart technologies